

User Instruction Manual Hoyer® Twin Turner

To avoid injury, read user manual prior to use.

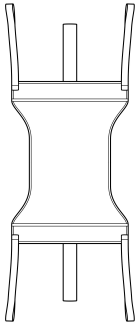

Standard Twin Turner

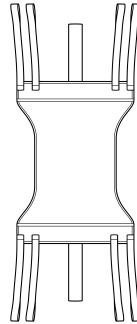
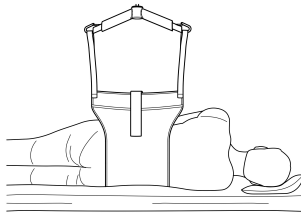

Large Twin Turner

⚠ WARNING

- **JOERNS RECOMMENDS THE USE OF GENUINE HOYER SLINGS.** Hoyer brand slings are approved by Joerns for use on Joerns brand lifts. Slings used on Joerns brand lifts, including Hoyer lifts, must be approved by Joerns.
- For the safety of the patient and carer; before using a sling a full risk assessment must be conducted to ensure that the correct sling choice, method of positioning in the sling and procedure for transfer has been determined for the patient.
- **CHECK** sling and stitching before each use. Using bleached, torn, cut, frayed or broken slings is unsafe and could result in serious injury or death to the patient.
- **DO NOT** alter slings. Destroy and discard worn slings.
- **NEVER** leave a patient unattended.
- **DO NOT** exceed the rated capacity of the sling or lift.
- **DO NOT** attempt to re-position a patient by pulling on the sling loops.

Introduction

The Twin Turner sling is used to assist in turning or “log rolling” a patient as well as maintaining them in position for purposes of hygiene or other care tasks. It is designed to be easily placed and removed as well as providing more access to the patient to provide skin care.

How to Use the Twin Turner Sling

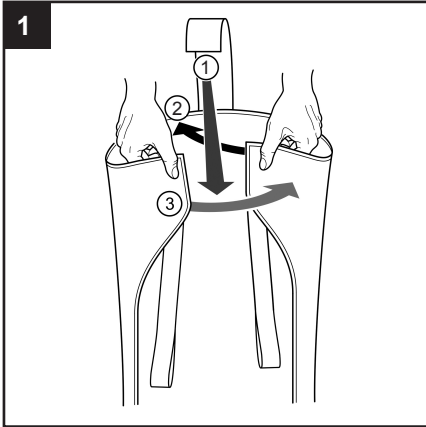

From one end, fold the Velcro straps against the label side of the sling. Fold the edges and loop straps over the Velcro straps, “encasing” all straps.

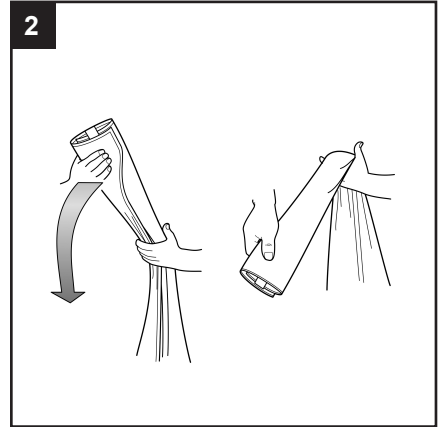

The above drawing indicates how the folded sling should look.

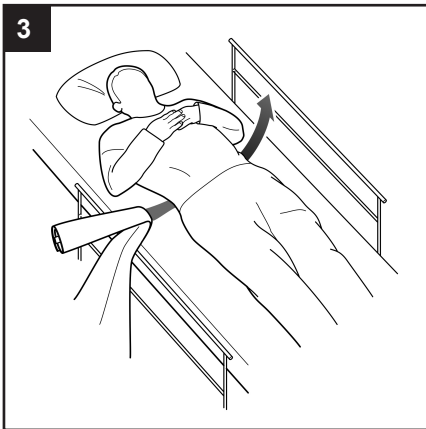

With the patient lying on their back, position the folded end of the sling, folded side down, on the bed surface at the patient’s lumbar. Push the sling with your hand, palm down, into the bed surface and under the patient.

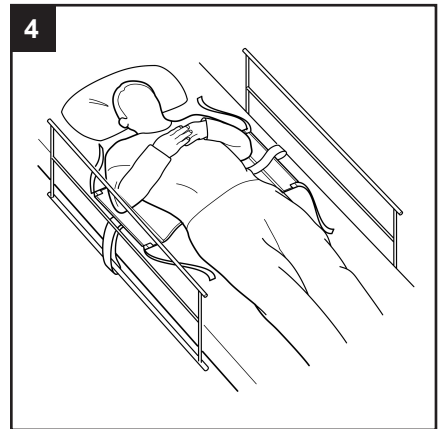

Position the sling to the side of the bed and secure the Velcro strap to a stable part of the bed frame.

How to Use the Twin Turner Sling

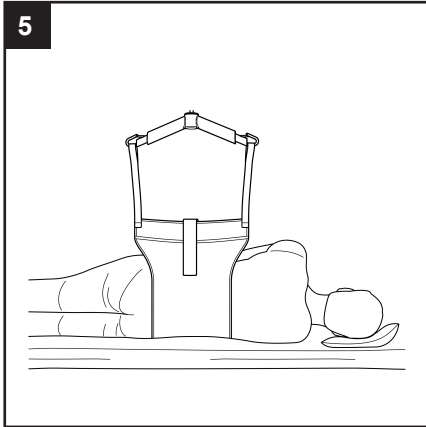

⚠ WARNING

Be sure to keep the side rails of the bed up and secure when turning a patient.

Attach the loop straps to the lift spreader bar as pictured. Lift and turn the patient while using your free hand to steady the patient.

For Large Sizes Only:

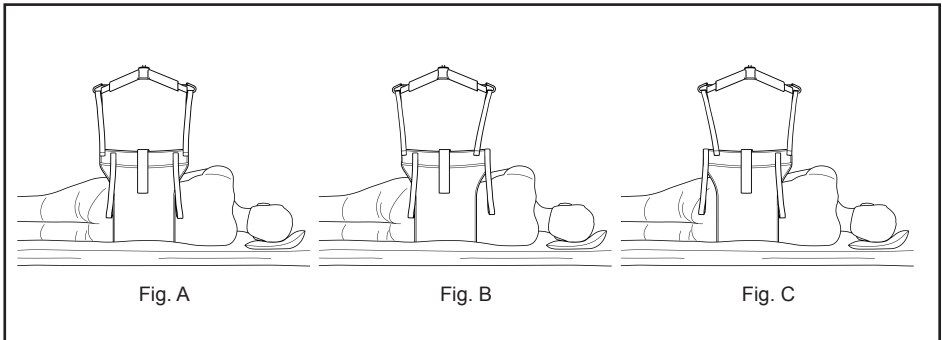

The LARGE Twin Turner is designed to be wider and longer to accommodate larger individuals. For most transfers, the outside straps are attached to the spreader bar for turning (Fig. A). The additional straps enable the caregiver to redistribute the pressure from the Twin Turner either higher or lower across the patient, increasing both performance and comfort (Fig. B and C). This functionality can save valuable time in having to re-apply or adjust the Twin Turner.

Technical Specifications

STANDARDS	EN ISO 10535, CE
SAFE WORKING LOAD	625lbs / 283kg

Sizing & Part Numbers

SIZE	PART NUMBER
STANDARD	NA25705
LARGE	NA25706

Washing Instructions



Machine wash at 185°F.



DO NOT wash with bleach. Bleach will damage the sling's material and make it unsafe for use.



Cool tumble dry, air dry or dry at very low temperature.



DO NOT dry clean.

⚠ WARNING

Slings can suffer damage during washing and drying and should be checked carefully before each use.

Additional slings are available to suit individual needs. Contact your Joerns representative for more information.